

**Pneumatic - Spring**

Coding: 805.1.11.1

Operational characteristics	
Fluid	Filtered air. No lubrication needed, if applied it shall be continuous
Max working pressure (bar)	10
Temperature °C	-5 ÷ +70
Flow rate at 6 bar with Δp=1 (NI/min)	160
Orifice size (mm)	2.5
Working ports size	M5
Pilot ports size	M5

TYPE	
32	= 3 ways
52	= 5 ways

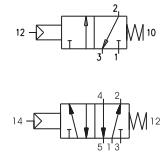

3 ways



Weight 45 g  
Minimum piloting pressure 2 bar

805.32.11.1

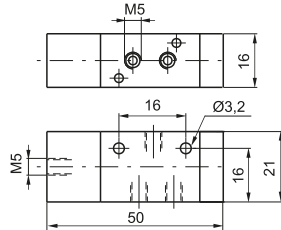

5 ways



Weight 50 g  
Minimum piloting pressure 2 bar

805.52.11.1

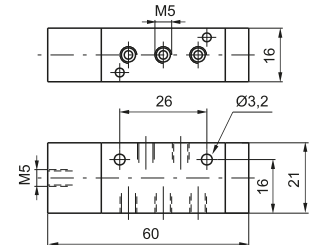

**Pneumatic - Differential**

Coding: 805.1.11.12

Operational characteristics	
Fluid	Filtered air. No lubrication needed, if applied it shall be continuous
Max working pressure (bar)	10
Temperature °C	-5 ÷ +70
Flow rate at 6 bar with Δp=1 (NI/min)	160
Orifice size (mm)	2.5
Working ports size	M5
Pilot ports size	M5

TYPE	
32	= 3 ways
52	= 5 ways

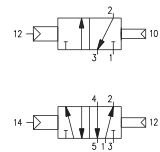

3 ways



Weight 50 g  
Minimum piloting pressure 2 bar

805.32.11.12

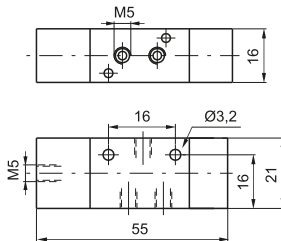

5 ways



Weight 55 g  
Minimum piloting pressure 2 bar

805.52.11.12

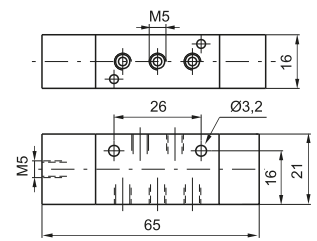

**Pneumatic - Pneumatic**

Coding: 805.1.11.11

Operational characteristics	
Fluid	Filtered air. No lubrication needed, if applied it shall be continuous
Max working pressure (bar)	10
Temperature °C	-5 ÷ +70
Flow rate at 6 bar with Δp=1 (NI/min)	160
Orifice size (mm)	2.5
Working ports size	M5
Pilot ports size	M5

TYPE	
32	= 3 ways
52	= 5 ways

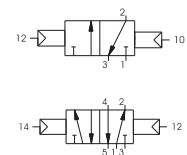

3 ways



Weight 55 g  
Minimum piloting pressure 1,5 bar

805.32.11.11

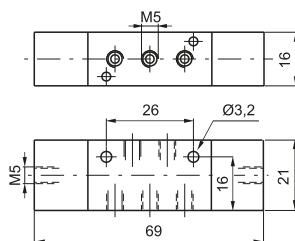

5 ways 2 connections



Weight 60 g  
Minimum piloting pressure 1,5 bar

805.52.11.11

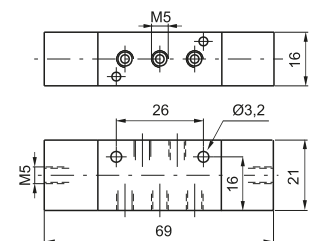

**Pneumatic - Spring**

Coding: 808.11.1

**Operational characteristics**

Fluid	Filtered air. No lubrication needed, if applied it shall be continuous
Max working pressure (bar)	10
Temperature °C	-5 ÷ +70
Flow rate at 6 bar with Δp=1 (NI/min)	520
Orifice size (mm)	4
Working ports size	G1/8"
Pilot ports size	M5

TYPE
① 32 = 3 ways
52 = 5 ways

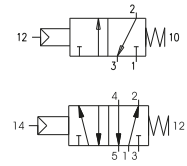

*Pneumatic - Spring*

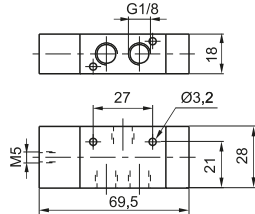

Weight 95 g  
Minimum piloting pressure 2 bar

808.32.11.1

*Pneumatic - Spring*

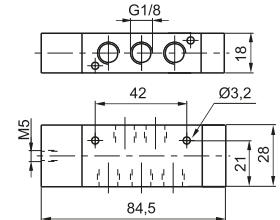

Weight 100 g  
Minimum piloting pressure 2 bar

808.52.11.1

**Pneumatic - Differential**

Coding: 808.11.12

**Operational characteristics**

Fluid	Filtered air. No lubrication needed, if applied it shall be continuous
Max working pressure (bar)	10
Temperature °C	-5 ÷ +70
Flow rate at 6 bar with Δp=1 (NI/min)	520
Orifice size (mm)	4
Working ports size	G1/8"
Pilot ports size	M5

TYPE
① 32 = 3 ways
52 = 5 ways

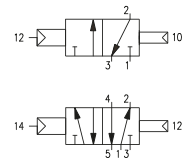

*Pneumatic - Differential external*

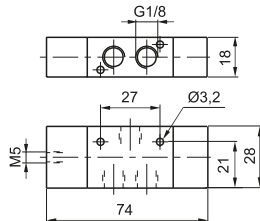

Weight 105 g  
Minimum piloting pressure 2 bar

808.32.11.12

*Pneumatic - Differential external*

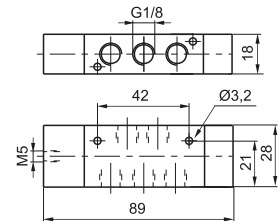

Weight 110 g  
Minimum piloting pressure 2 bar

808.52.11.12

**Pneumatic - Pneumatic**

Coding: 808.11.11

**Operational characteristics**

Fluid	Filtered air. No lubrication needed, if applied it shall be continuous
Max working pressure (bar)	10
Temperature °C	-5 ÷ +70
Flow rate at 6 bar with Δp=1 (NI/min)	520
Orifice size (mm)	4
Working ports size	G1/8"
Pilot ports size	M5

TYPE
① 32 = 3 ways
52 = 5 ways

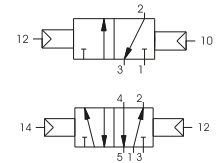

*Pneumatic-pneumatic*

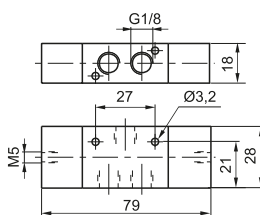

Weight 115 g  
Minimum piloting pressure 1,5 bar

808.32.11.11

*Pneumatic-pneumatic*

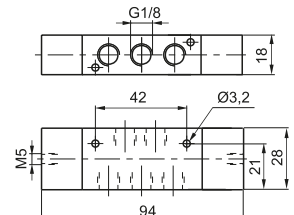

Weight 120 g  
Minimum piloting pressure 1,5 bar

808.52.11.11

**Pneumatic - Pneumatic**

Coding: 808.53.1.11.11

Operational characteristics	
Fluid	Filtered air. No lubrication needed, if applied it shall be continuous
Max working pressure (bar)	10
Temperature °C	-5 ÷ +70
Flow rate at 6 bar with Δp=1 (Nl/min)	520
Orifice size (mm)	4
Working ports size	G 1/8"
Pilot ports size	M5

TYPE	
31	= Closed centres
32	= Open centres

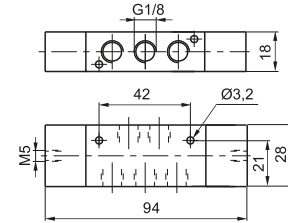
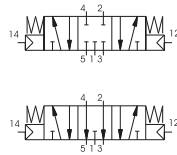

Weight 125 g  
Minimum piloting pressure 3 bar

1  
AIR DISTRIBUTION