

Pneumatic - Spring

Coding: 224.11.1

Operational characteristics	
Fluid	Filtered air. No lubrication needed, if applied it shall be continuous
Max working pressure (bar)	10
Temperature °C	-5 ÷ +70
Flow rate at 6 bar with Δp=1 (NI/min)	1360
Orifice size (mm)	8
Working ports size	G1/4"
Pilot ports size	G1/8"

TYPE	
32	= 3 ways
52	= 5 ways

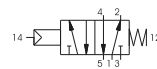
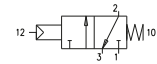

Weight 370 g
Minimum piloting pressure 2,5 bar

224.32.11.1

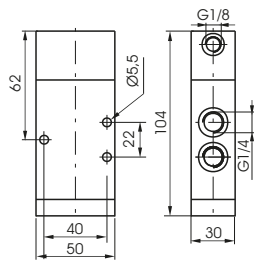

5 ways



Weight 450 g
Minimum piloting pressure 2,5 bar

224.52.11.1

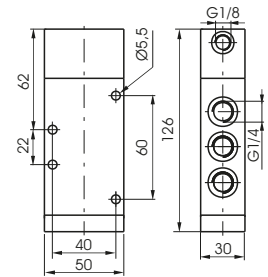

Pneumatic - Differential external

Coding: 224.11.12

Operational characteristics	
Fluid	Filtered air. No lubrication needed, if applied it shall be continuous
Max working pressure (bar)	11
Temperature °C	-5 ÷ +70
Flow rate at 6 bar with Δp=1 (NI/min)	1360
Orifice size (mm)	8
Working ports size	G1/4"
Pilot ports size	G1/8"

TYPE	
32	= 3 ways
52	= 5 ways

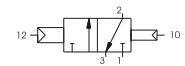

3 ways



Weight 480 g
Minimum piloting pressure 2,5 bar

224.32.11.12

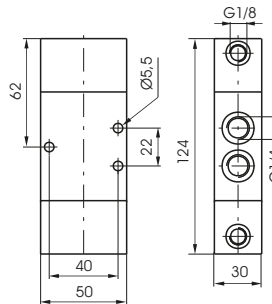

5 ways



Weight 550 g
Minimum piloting pressure 2,5 bar

224.52.11.12

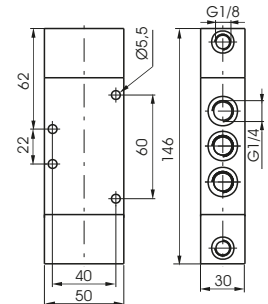

Pneumatic - Pneumatic

Coding: 224.11.11

Operational characteristics	
Fluid	Filtered air. No lubrication needed, if applied it shall be continuous
Max working pressure (bar)	12
Temperature °C	-5 ÷ +70
Flow rate at 6 bar with Δp=1 (NI/min)	1360
Orifice size (mm)	8
Working ports size	G1/4"
Pilot ports size	G1/8"

TYPE	
32	= 3 ways
52	= 5 ways

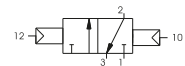

3 ways



Weight 470 g
Minimum piloting pressure 2 bar

224.32.11.11

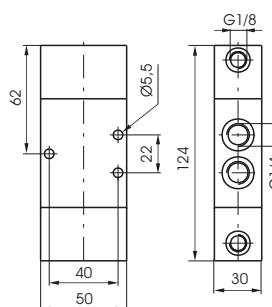

5 ways



Weight 540 g
Minimum piloting pressure 2 bar

224.52.11.11

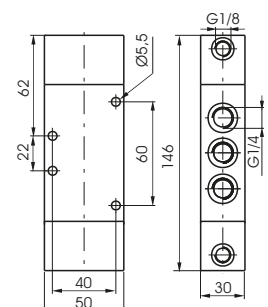



Pneumatic - Pneumatic 5 ways 3 connections

Coding: 224.53.F.11.11

Operational characteristics

Fluid	Filtered air. No lubrication needed, if applied it shall be continuous
Max working pressure (bar)	13
Temperature °C	-5 ÷ +70
Flow rate at 6 bar with $\Delta p=1$ (NI/min)	1280
Orifice size (mm)	8
Working ports size	G1/4"
Pilot ports size	G1/8"

FUNCTION	
31	= Closed centres
32	= Open centres
33	= Pressured centres

1
AIR DISTRIBUTION

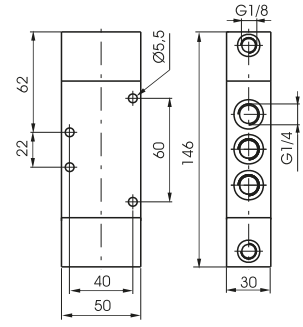
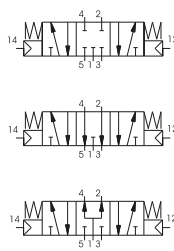

Weight 550 g
 Minimum piloting pressure 3 bar

Pneumatic - Spring

Coding: T224.1.11.1

Operational characteristics

Fluid	Filtered air. No lubrication needed, if applied it shall be continuous
Max working pressure (bar)	10
Temperature °C	-5 ÷ +50
Flow rate at 6 bar with Δp=1 (NI/min)	1050
Orifice size (mm)	8.5
Working ports size	G1/4"
Pilot ports size	G1/8"

TYPE	
① 32 = 3 ways	
52 = 5 ways	

Minimum piloting pressure 2,5 bar

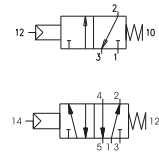

AIR DISTRIBUTION

3 ways



Weight 110 g

T224.32.11.1

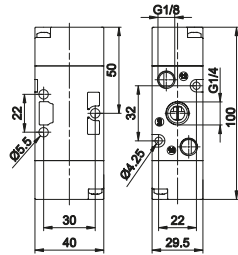

5 ways



Weight 140 g

T224.52.11.1

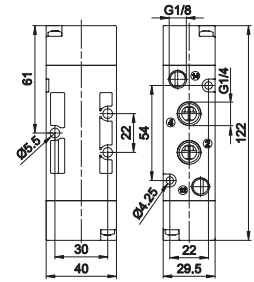

Pneumatic - Differential external

Coding: T224.1.11.12

Operational characteristics

Fluid	Filtered air. No lubrication needed, if applied it shall be continuous
Max working pressure (bar)	10
Temperature °C	-5 ÷ +50
Flow rate at 6 bar with Δp=1 (NI/min)	1050
Orifice size (mm)	8.5
Working ports size	G1/4"
Pilot ports size	G1/8"

TYPE	
① 32 = 3 ways	
52 = 5 ways	

Minimum piloting pressure 2 bar

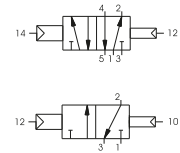

3 ways



Weight 110 g

T224.32.11.12

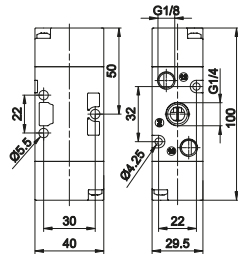

5 ways



Weight 140 g

T224.52.11.12

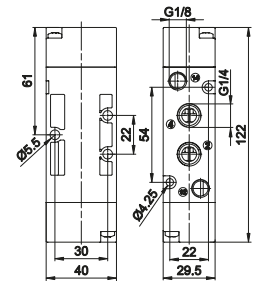

Pneumatic - Pneumatic

Coding: T224.1.11.11

Operational characteristics

Fluid	Filtered air. No lubrication needed, if applied it shall be continuous
Max working pressure (bar)	10
Temperature °C	-5 ÷ +50
Flow rate at 6 bar with Δp=1 (NI/min)	1050
Orifice size (mm)	8.5
Working ports size	G1/4"
Pilot ports size	G1/8"

TYPE	
① 32 = 3 ways	
52 = 5 ways	

Minimum piloting pressure 2 bar

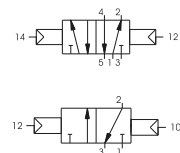

3 ways



Weight 110 g

T224.32.11.11

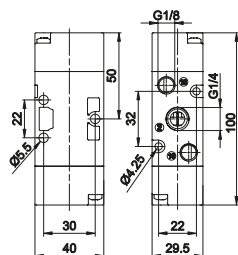

5 ways



Weight 140 g

T224.52.11.11

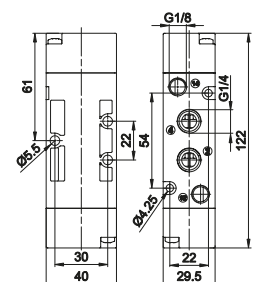

Pneumatic - Pneumatic 5 ways 3 connections

Coding: T224.53.F.11.11

Operational characteristics	
Fluid	Filtered air. No lubrication needed, if applied it shall be continuous
Max working pressure (bar)	10
Temperature °C	-5 ÷ +50
Flow rate at 6 bar with $\Delta p=1$ (l/min)	900
Orifice size (mm)	8.5
Working ports size	G1/4"
Pilot ports size	G1/8"

FUNCTION	
F	31 = Closed centres
	32 = Open centres
	33 = Pressured centres

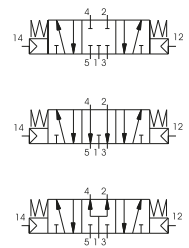
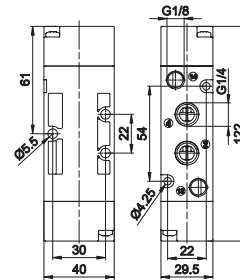

Weight 160 g
Minimum piloting pressure 3 bar

1
AIR DISTRIBUTION