



**Pneumatic - Spring**

Coding: 212.11.1

**Operational characteristics**

Fluid	Filtered air. No lubrication needed, if applied it shall be continuous
Max working pressure (bar)	10
Temperature °C	-5 ÷ +70
Flow rate at 6 bar with Δp=1 (NI/min)	3500
Orifice size (mm)	15
Working ports size	G1/2"
Pilot ports size	G1/8"

TYPE
32 = 3 ways
52 = 5 ways

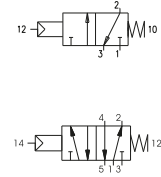

3 ways

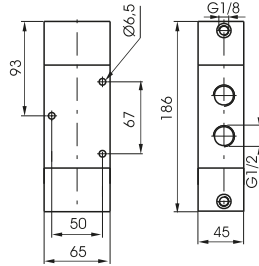

Weight 1110 g  
Minimum piloting pressure 2,5 bar

212.32.11.1

5 ways

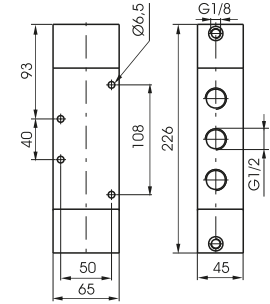

Weight 1390 g  
Minimum piloting pressure 2,5 bar

212.52.11.1

**Pneumatic - Differential external**

Coding: 212.11.12

**Operational characteristics**

Fluid	Filtered air. No lubrication needed, if applied it shall be continuous
Max working pressure (bar)	10
Temperature °C	-5 ÷ +70
Flow rate at 6 bar with Δp=1 (NI/min)	3500
Orifice size (mm)	15
Working ports size	G1/2"
Pilot ports size	G1/8"

TYPE
32 = 3 ways
52 = 5 ways

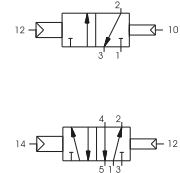

3 ways

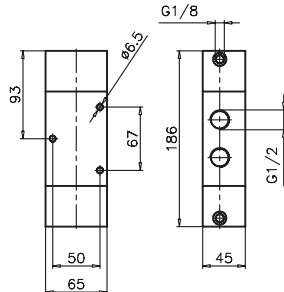

Weight 1380 g  
Minimum piloting pressure 2,5 bar

212.32.11.12

5 ways

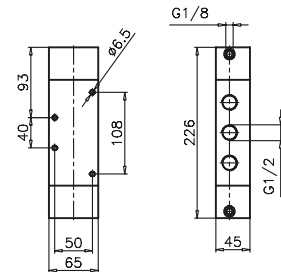

Weight 1660 g  
Minimum piloting pressure 2,5 bar

212.52.11.12

**Pneumatic - Pneumatic**

Coding: 212.11.11

**Operational characteristics**

Fluid	Filtered air. No lubrication needed, if applied it shall be continuous
Max working pressure (bar)	10
Temperature °C	-5 ÷ +70
Flow rate at 6 bar with Δp=1 (NI/min)	3500
Orifice size (mm)	15
Working ports size	G1/2"
Pilot ports size	G1/8"

TYPE
32 = 3 ways
52 = 5 ways

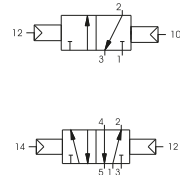

3 ways

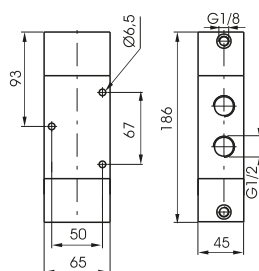

Weight 1350 g  
Minimum piloting pressure 2 bar

212.32.11.11

5 ways

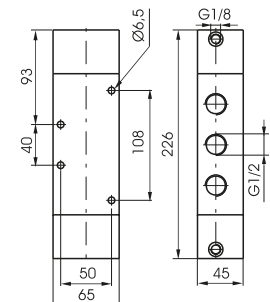

Weight 1630 g  
Minimum piloting pressure 2 bar

212.52.11.11

AIR DISTRIBUTION

**Pneumatic - Pneumatic 5 ways 3 connections**

Coding: 212.53.Ⓕ.11.11

Operational characteristics	
Fluid	Filtered air. No lubrication needed, if applied it shall be continuous
Max working pressure (bar)	10
Temperature °C	-5 ÷ +70
Flow rate at 6 bar with Δp=1 (NI/min)	3000
Orifice size (mm)	15
Working ports size	G1/2"
Pilot ports size	G1/8"

FUNCTION	
Ⓕ1	= Closed centres
Ⓕ2	= Open centres
Ⓕ3	= Pressured centres

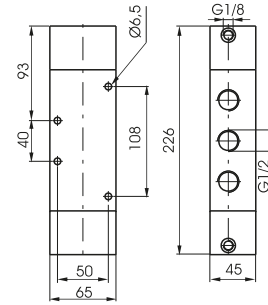
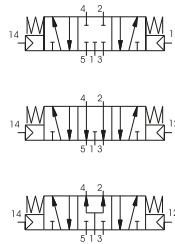

Weight 1650 g  
Minimum piloting pressure 3 bar

**Pneumatic - Differential external**

Coding: 212/2.11.1

**Operational characteristics**

Fluid	Filtered air. No lubrication needed, if applied it shall be continuous
Max working pressure (bar)	10
Temperature °C	-5 ÷ +70
Flow rate at 6 bar with Δp=1 (NI/min)	3600
Orifice size (mm)	15
Working ports size	G1/2"
Pilot ports size	G1/8"

TYPE
32 = 3 ways
52 = 5 ways

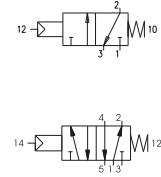

AIR DISTRIBUTION

3 ways

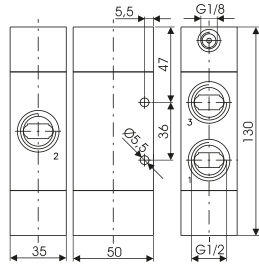

Weight 524 g  
Minimum piloting pressure 2,5 bar

212/2.32.11.1

5 ways

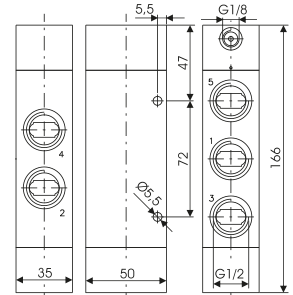

Weight 644 g  
Minimum piloting pressure 2,5 bar

212/2.52.11.1

**Pneumatic - Differential self aligned**

Coding: 212/2.11.12

**Operational characteristics**

Fluid	Filtered air. No lubrication needed, if applied it shall be continuous
Max working pressure (bar)	10
Temperature °C	-5 ÷ +70
Flow rate at 6 bar with Δp=1 (NI/min)	3600
Orifice size (mm)	15
Working ports size	G1/2"
Pilot ports size	G1/8"

TYPE
32 = 3 ways
52 = 5 ways

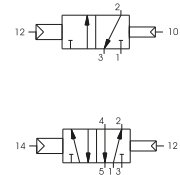

3 ways

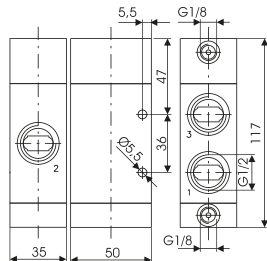

Weight 464 g  
Minimum piloting pressure 2,5 bar

212/2.32.11.12

5 ways

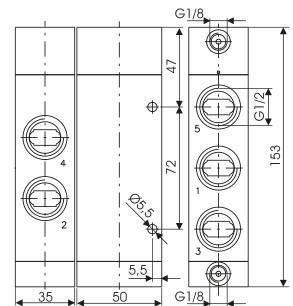

Weight 586 g  
Minimum piloting pressure 2,5 bar

212/2.52.11.12

**Pneumatic - Pneumatic**

Coding: 212/2.11.12.F

**Operational characteristics**

Fluid	Filtered air. No lubrication needed, if applied it shall be continuous
Max working pressure (bar)	10
Temperature °C	-5 ÷ +70
Flow rate at 6 bar with Δp=1 (NI/min)	3600
Orifice size (mm)	15
Working ports size	G1/2"
Pilot ports size	G1/8"

TYPE
32 = 3 ways
52 = 5 ways
FUNCTION
1.C = Normally closed
1.A = Normally open
1 = Self-feeding

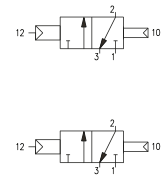

3 ways

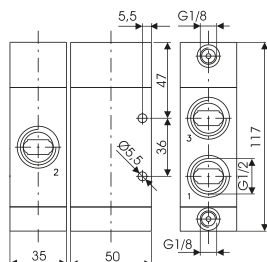

Weight 466 g  
Minimum piloting pressure 2,5 bar

212/2.32.11.12/F

5 ways

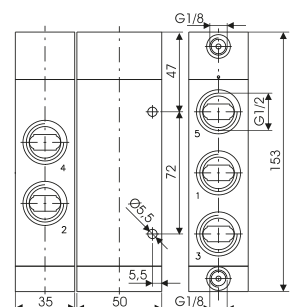

Weight 588 g  
Minimum piloting pressure 2,5 bar

212/2.52.11.12/F

**Amplified pneumatic - Spring**

Coding: 212/2.11.11

Operational characteristics	
Fluid	Filtered air. No lubrication needed, if applied it shall be continuous
Max working pressure (bar)	10
Temperature °C	-5 ÷ +70
Flow rate at 6 bar with Δp=1 (Nl/min)	3600
Orifice size (mm)	15
Working ports size	G1/2"
Pilot ports size	G1/8"

TYPE	
32	= 3 ways
52	= 5 ways

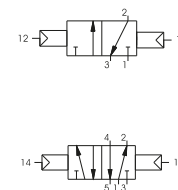

Weight 518 g  
Minimum piloting pressure 2,5 bar

212/2.32.11.11

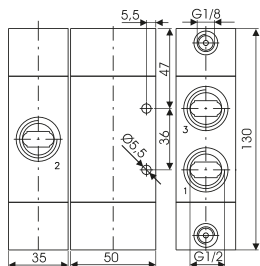

5 ways



Weight 640 g  
Minimum piloting pressure 2,5 bar

212/2.52.11.11

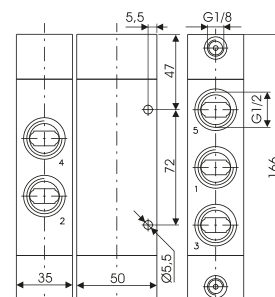

1

AIR DISTRIBUTION

**Pneumatic - Pneumatic 5 ways 3 connections**

Coding: 212/2.53.11.11

Operational characteristics	
Fluid	Filtered air. No lubrication needed, if applied it shall be continuous
Max working pressure (bar)	10
Temperature °C	-5 ÷ +70
Flow rate at 6 bar with Δp=1 (Nl/min)	3300
Orifice size (mm)	15
Working ports size	G1/2"
Pilot ports size	G1/8"

FUNCTION	
31	= Closed centres
32	= Open centres
33	= Pressured centres



Weight 684 g  
Minimum piloting pressure 3 bar

